

# Manual

for the professional craftsman

**SIGA**  1966

# building-tight

**WIND + WEATHER TIGHTNESS**    **AIR + VAPOR TIGHTNESS**



**Stick with us.**

# CONTENTS

SCIENCE OF BUILD-TIGHT.....	p.4
EXTERIOR APPLICATIONS.....	p. 9
INTERIOR APPLICATIONS.....	p. 21
PRODUCT INFORMATION.....	p. 26
WARRANTY INFORMATION.....	p. 32
SUBSTRATE MATRIX.....	p. 34
ABOUT SIGA.....	p. 35

# PROGRESSION OF THE MODERN BUILDING ENVELOPE

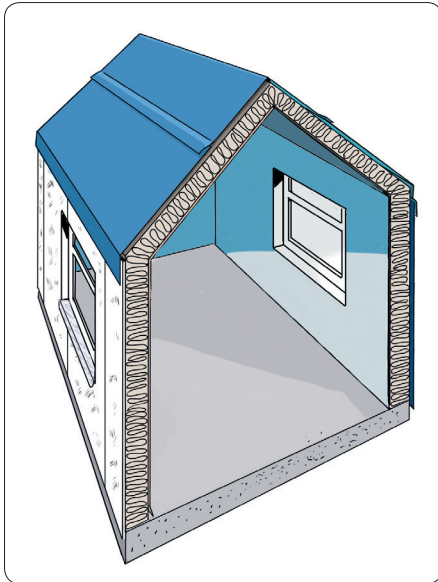

## 1. MINIMUM

- Rainproof and weather resistive

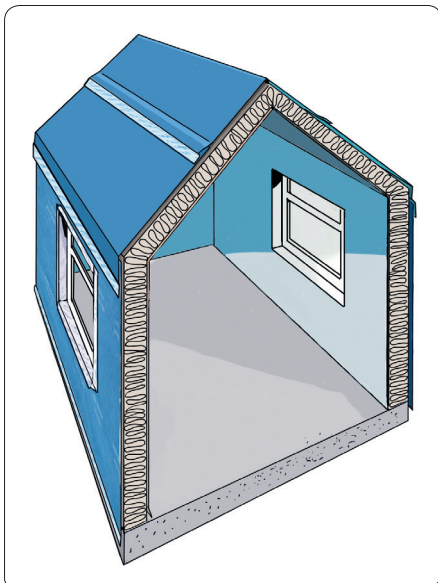

## 2. CONTINUOUS WEATHER RESISTIVE LAYER

- Rainproof and weather resistive
- Air leakage reduced
- More efficient heating and cooling possible

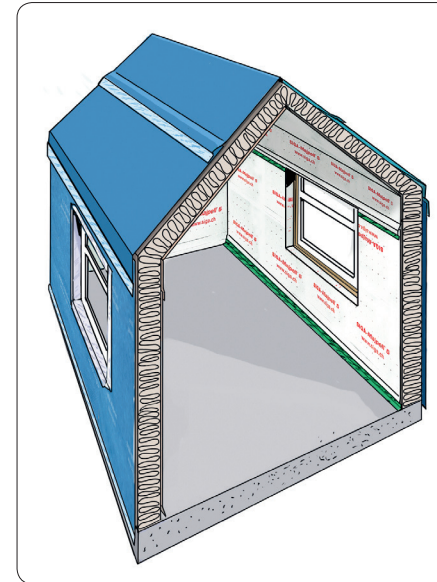

## 3. CONTINUOUS WEATHER RESISTIVE LAYER + VAPOR CONTROL LAYER

- Rainproof and weather resistive
- Air leakage prevented
- Most efficient heating and cooling possible
- Maximize user comfort
- Maximize building health

### WITH A SIGA-SEALED BUILDING

- ✓ **CONSERVE** energy for heating in the winter and for cooling in the summer over a lifetime.
- ✓ **ACHIEVE** a high standard of comfort – without drafts and noise.
- ✓ **REDUCE** the CO2 emission as well as the dependency on oil and power.
- ✓ **INCREASE** the value of your house over the long term.

SIGA a small investment that pays off for a lifetime.

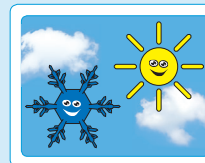

- ✓ high adhesive strength at low and high temperatures



- ✓ resistant to ageing



- ✓ without any residential toxins

## NO EXTERIOR SEALING

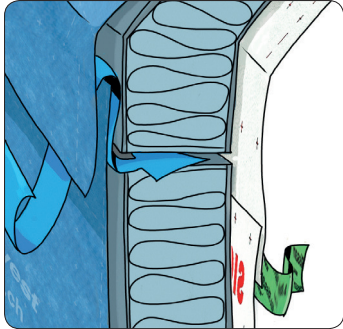

- Cold outside air hits warm inside surface

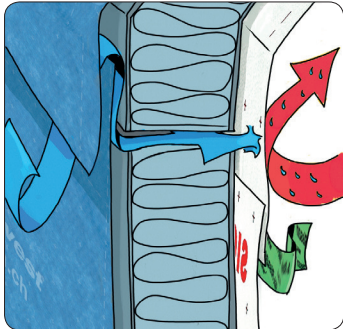

- Risk of condensation!

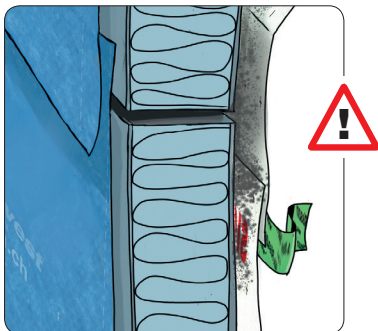

- Condensation can lead to mold growth

## Solution

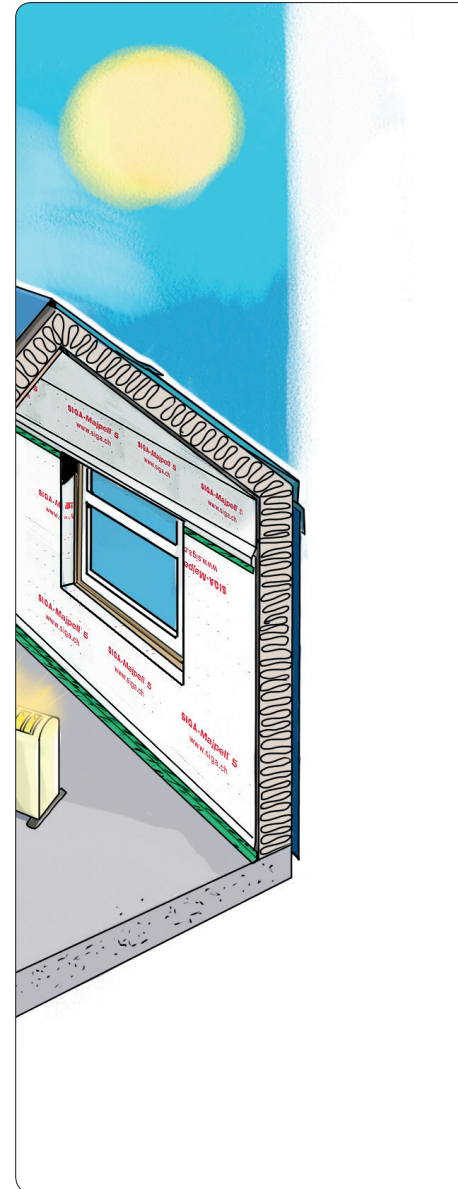

## NO INTERIOR SEALING

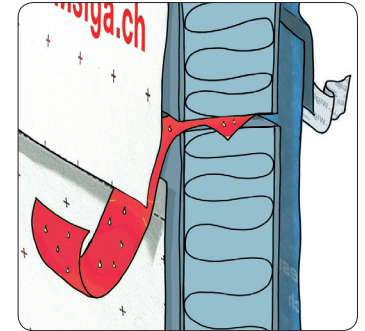

- Warm inside air hits cold outside surface

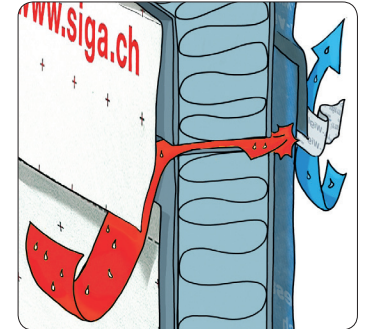

- Risk of condensation!

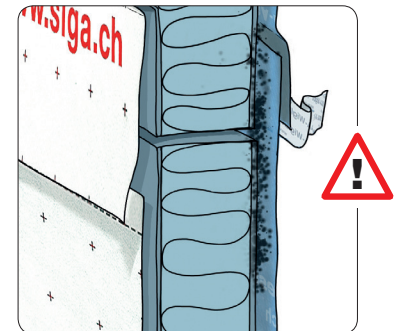

- Condensation can lead to mold growth



# EXTERIOR APPLICATION

## WEATHER-RESISTIVE BARRIER INSTALLATION



**BUILDING WRAP MOUNTING** ..... p. 10



**SEAM & JOINT SEALING**..... p. 11

## WINDOW FLASHING

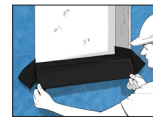

**NAIL FLANGE WINDOWS**..... p. 12



**NON-FLANGED WINDOWS**..... p. 17

## THRU-WALL FLASHING



**BASE JOINT SEALING**..... p. 18

## PENETRATIONS



**ROUND PENETRATION SEALING**..... p. 20

## BUILDING WRAP MOUNTING

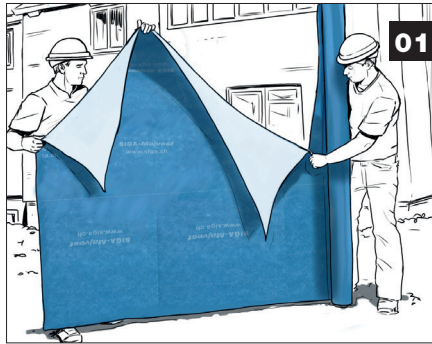

- Unroll Majvest and cut it to size

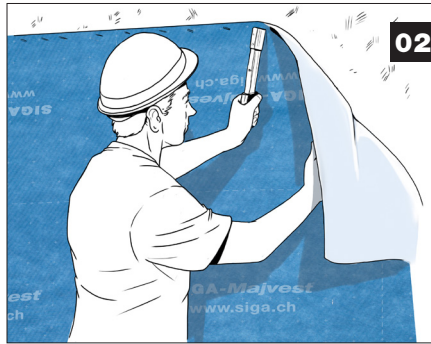

- Fasten securely with the blue, printed side facing outward.
- Use fasteners and fastening schedule that are appropriate for the specific application.

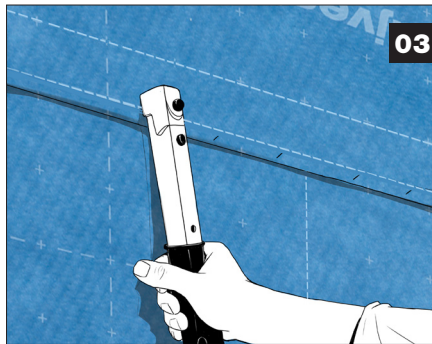

- Minimum overlap for vertical and horizontal seams is 4"
- Use the overlap guide on factory edges



**Majvest®**

p. 26

## SEAM AND JOINT SEALING

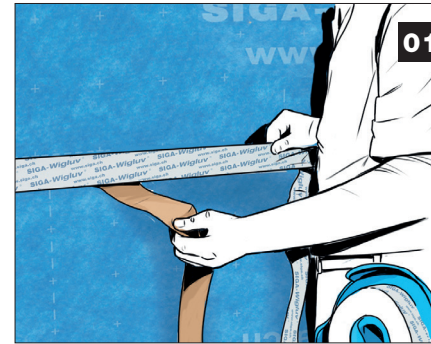

- Align Wigluv 60 with the dashed tape-centering line, imprinted along the factory edge
- For panelized materials, center Wigluv 60 evenly over the Joint

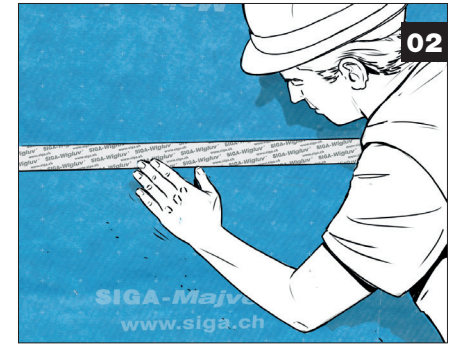

- Apply it without tension and creases and **press on** firmly with hand pressure



**Wigluf® 60**

p. 27

## NAIL FLANGE WINDOW FLASHING

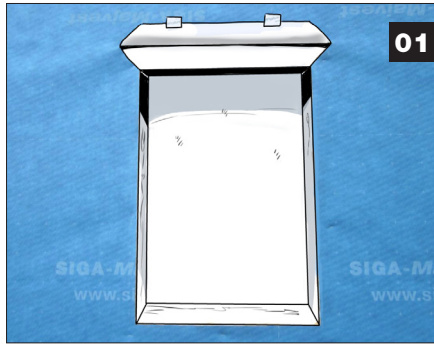

- Cut the Majvest flush with the rough opening (RO)
- Make two cuts at the upper corners of the RO: each at a 45° angle, to a point 9" up and out
- Fold flap upwards and fasten temporarily

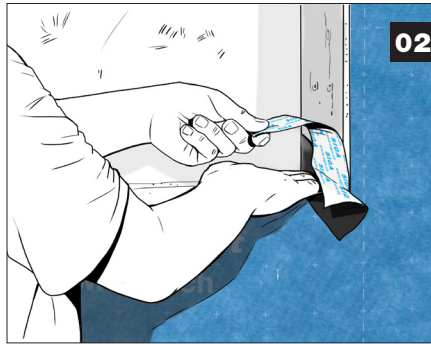

- Cut a length of Fentrim F (4" or 6" width) to fit the depth of sill plus 3" to overhang the exterior
- Fold Fentrim F along the split backing
- Slide into corner
- Peel off one backing strip after another and press on firmly

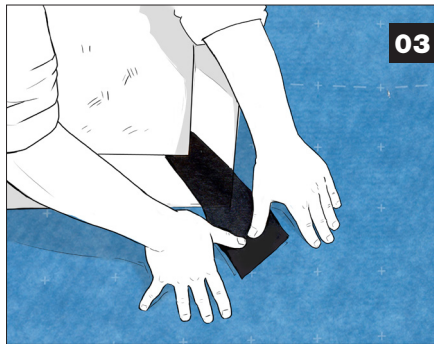

- Starting at the corner, spread the loose end of Fentrim F gradually onto the wall face
- Use both thumbs for a uniform application
- Press on firmly
- Repeat Steps 2 and 3 to seal all corners

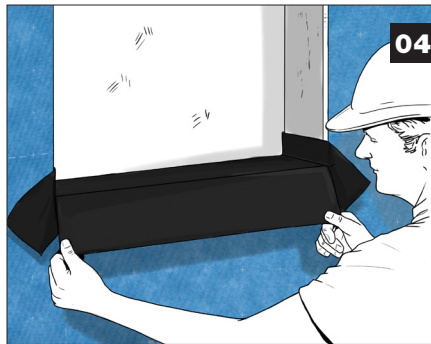

- Cut Fentrim F (6" or wider) to length: inside to inside of the RO
- Fold Fentrim F along the split backing
- Release one backing strip and seal to RO
- Release other backing strip and seal to the wall face / facade
- Press on firmly

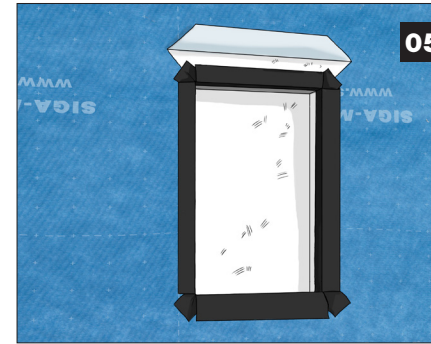

- Repeat Step 4 to seal all edges of the RO: sill, jambs, and head
- How it should look (above)



- Install the window according to the manufacturer's instructions
- Unless specified, sealant is not required behind the nail flange



- Use Fentrim F (4" or wider) to counter-flash the flange in weather-lap fashion
- Bottom flange remains untaped
- Jamb flashing extends 2" past lower edge of flange
- Head flashing extends 1" past the outer edges of the jamb flashing

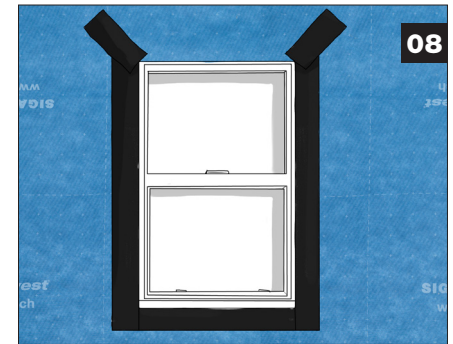

- Drape the Majvest flap over the head flashing
- Seal the 45° cuts with Fentrim F
- Window sealed according to ASTM E2112 and AAMA 2400



**Fentrim® F 4", 6", 9" & 12"**

p. 28



## NAIL FLANGE WINDOW FLASHING (ALTERNATE)

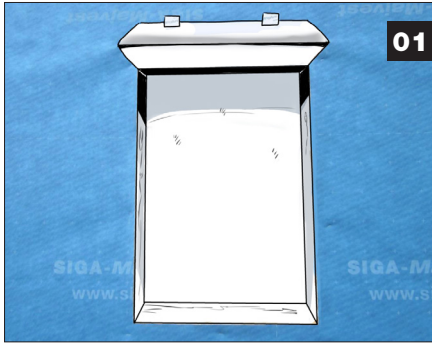

- Cut the Majvest flush with the rough opening (RO)
- Make two cuts at the upper corners of the RO: each at a 45° angle, to a point 9" up and out
- Fold flap upwards and fasten temporarily

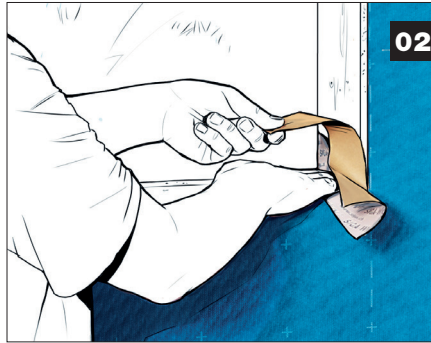

- Cut a length of Wiclup (4" width) to fit the depth of sill plus 3" to overhang the exterior
- Fold Wiclup along the split backing
- Slide into corner
- Peel off one backing strip after another and press on firmly



- Pull the loose end of Wiclup down and away from the corner
- Using minimal tension, flatten onto wall face
- Wrinkles are normal
- Press on firmly
- Repeat Steps 2 and 3 to seal all corners



- Cut Wiclup (6" or wider) to length: inside to inside of the RO
- Fold Wiclup along the split backing
- Release one backing strip and seal to RO
- Release other backing strip and seal to the wall face / facade
- Press on firmly

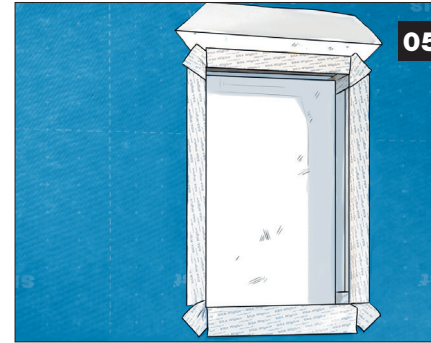

- Repeat Step 4 to seal all edges of the RO: sill, jambs, and head
- How it should look (above)



- Install the window according to the manufacturer's instructions
- Unless specified, sealant is not required behind the nail flange



- Use Wiclup (4" or wider) to counter-flash the flange in weather-lap fashion
- Bottom flange remains untaped
- Jamb flashing extends 2" past lower edge of flange
- Head flashing extends 1" past the outer edges of the jamb flashing

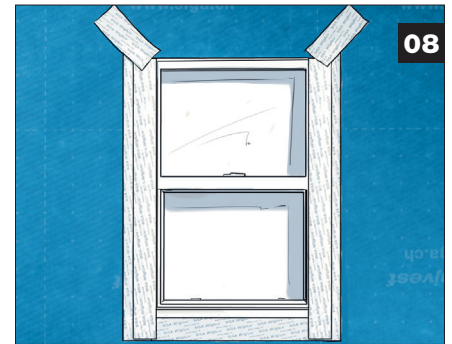

- Drape the Majvest flap over the head flashing
- Seal the 45° cuts with Wiclup
- Window sealed according to ASTM E2112 and AAMA 2400



**Wiclup® 100, 150 & 230**

p. 28



## NON-FLANGED WINDOW FLASHING

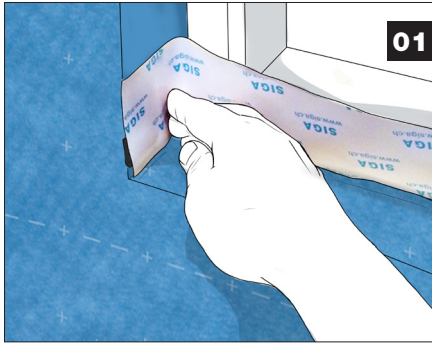

- Cut Fentrim IS 2 75 the full length of the sill, plus 3" at each end
- Justify folded edge of Fentrim IS 2 75 to bottom edge of the window face
- At each end, make a 90° turn and continue bonding onto jamb
- Press on firmly
- Remove entire backing strip

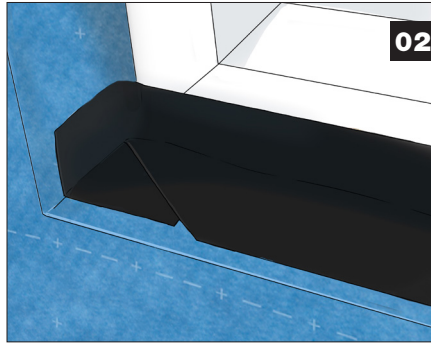

- Press tape **tightly** into corner of the RO, work towards the window
- Fold the tape onto itself, creating a triangle. Press on.
- Repeat at other end
- Adhere seam between window and sill, without tension



- Cut Fentrim IS 2 75 to full height of jamb
- Bond narrow side of Fentrim IS 2 75 to window face
- Remove backing strip
- Flatten prefold down, and press tape along length of corner
- Repeat on opposite jamb

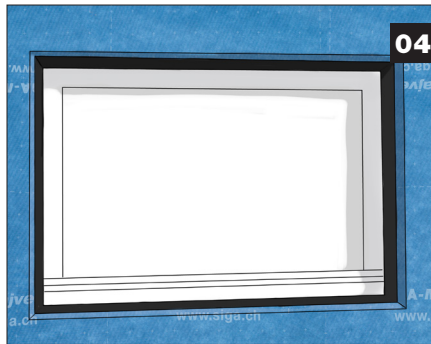

- Repeat Steps 1 & 2 (above) to seal head
- Press firmly on all tape connections
- How it should look



**Fentrim® IS 2 75**

p. 29

## NON-FLANGED WINDOW FLASHING (ALTERNATE)

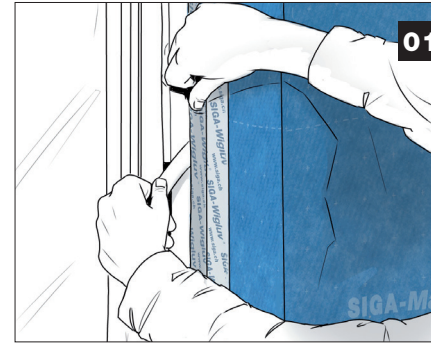

- Align Wigluv 20/40 in the corner
- Remove narrow backing strip
- Affix the narrow side to the window frame and press on



- Remove wide backing strip
- Affix the wide side to the prepared opening
- Repeat Steps 1 and 2 along all 4 sides of the window

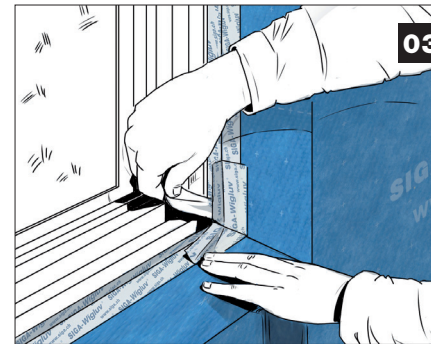

- Cut a 5" long piece of Wigluv 20/40
- Crease along the split back
- Fold again the short way
- Remove the wide backing strip
- Affix to the opening; ensure a tight fit at the inside corner
- Remove the narrow backing strip
- Affix to window and press on



- Repeat Steps 3 – 5 for each corner
- Windtight sealing of window using Wigluv 20/40



**Wiglurv® 20/40**

p. 29

## BASE JOINT SEALING

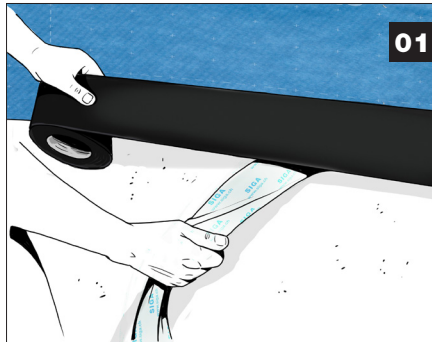

- Align Fentrim F to the center of the joint, secure in place
- Remove backing strip

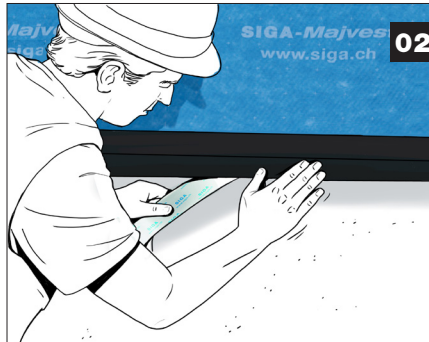

- Bond without any tension and wrinkles and press on firmly with hand pressure



**Fentrim® F 4", 6", 9" & 12"**

p. 28

Stick with us.

## BASE JOINT SEALING



- Bond the concrete base-joint with high-performance primer Dockskin
- Brush or roll on Dockskin primer to concrete and let it dry, clear and tacky



- Align Wigluv 100, 150 or 230 to the center of the joint, secure in place
- Remove backing strip



**Wigluv® 100, 150 & 230**

p. 28

**Dockskin®**

p. 27

[www.sigacover.com](http://www.sigacover.com)

ROUND PENETRATION SEALING

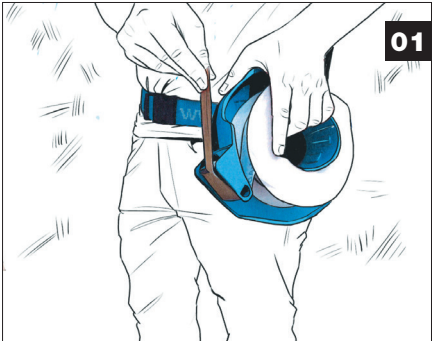

- Cut several 3“ pieces of Wigluv 60 with the dispenser or SIGA knife

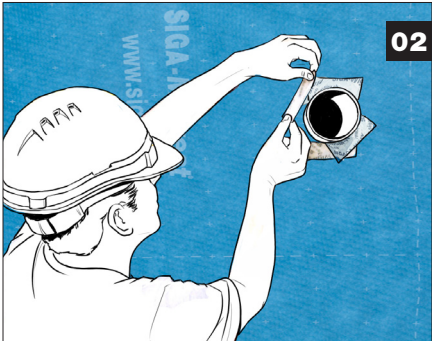

- Apply Wigluv 60 pieces half on the penetration and half on the wall
- Start from the bottom and work to the top
- Press firmly to adhere and seal Wigluv 60 to the penetration

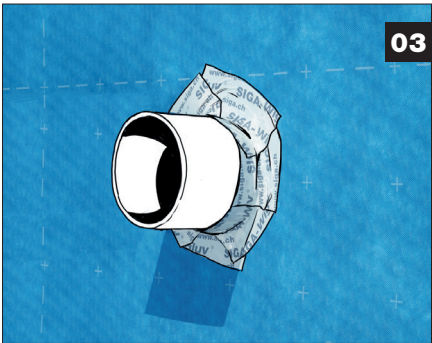

- How it should look

INTERIOR APPLICATION

VAPOR RETARDER INSTALLATION



VAPOR RETARDER MOUNTING..... p. 22



SEAM SEALING..... p. 23

WINDOW CONNECTION



INTERIOR WINDOW SEALING..... p. 25

PENETRATIONS

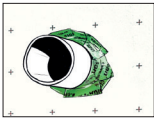

ROUND PENETRATION SEALING.....p. 24



Wigluv® 60

p. 27



## VAPOR RETARDER MOUNTING

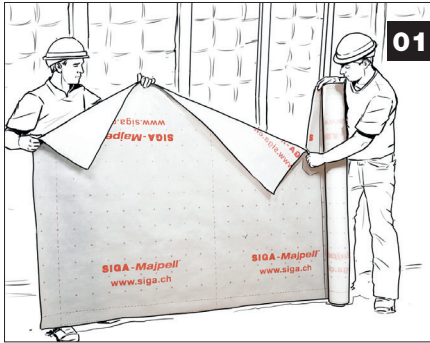

- Unroll Majpell 5 and cut it to size



- Bond Majpell 5 with the smooth side facing you
- Overlap the sheets along the overlap line
- Affix with staples



### After adhesion:

- Screw battens crosswise or lengthwise along the structure (to bear the weight of the insulation material)
- Mount the interior cladding



**Majpell®**

p. 30

## SEAM SEALING

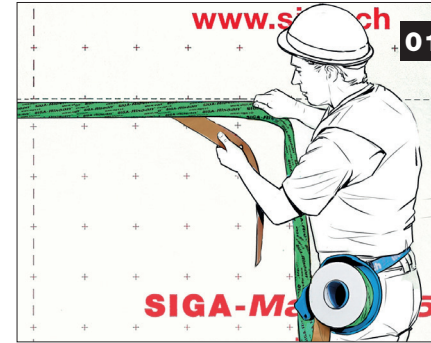

- Release the Rissan60 backing strip
- Position Rissan60 in the center of the overlap and secure it in place
- Remove the backing strip
- Apply Rissan60 free of tension



- Press on firmly!



- How it should look



**Rissan® 60**

p. 31



## ROUND PENETRATION SEALING



- Cut off short pieces of Rissan 60
- Apply Rissan 60 half to the pipe and half to the vapor control layer without tension

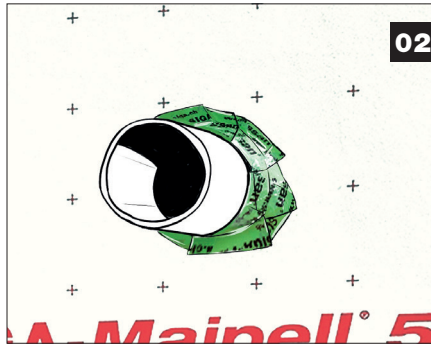

- Apply Rissan 60 around circular parts in layers

## TIPS AND TRICKS

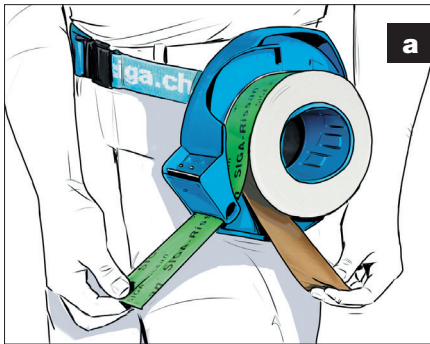

- For short pieces, separate Rissan 60 from its backing strip
- Pull on Rissan 60 and the backing strip simultaneously

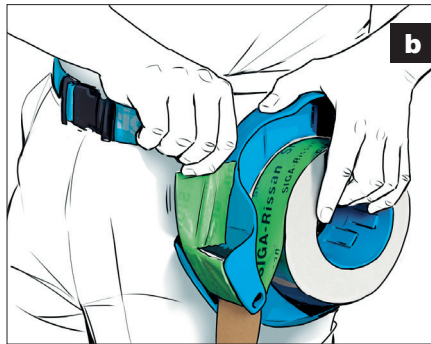

- Block Rissan 60 roll with one hand
- Use other hand to tear off Rissan 60 over blade with a quick jerking movement



**Rissan® 60**

p. 31

## INTERIOR WINDOW SEALING

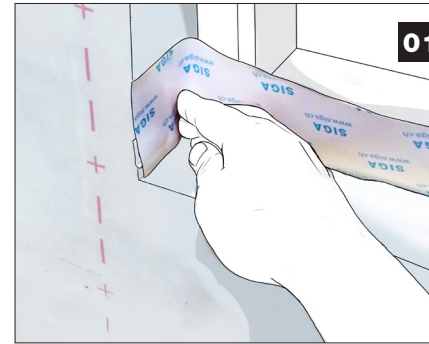

- Cut Fentrim IS 20 75 the full length of the sill, plus 3" at each end
- Justify folded edge of Fentrim IS 20 75 to bottom edge of the window face
- At each end, make a 90° turn and continue bonding onto jamb
- Press on firmly
- Remove entire backing strip

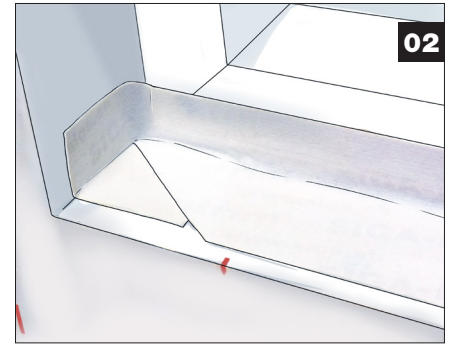

- Press tape **tightly** into corner of the RO, work towards the window
- Fold the tape onto itself, creating a triangle. Press on.
- Repeat at other end
- Adhere seam between window and sill, without tension

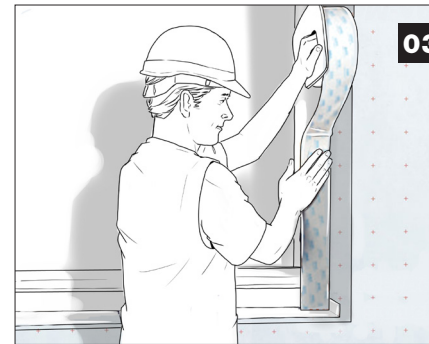

- Cut Fentrim IS 20 75 to full height of jamb
- Bond narrow side of Fentrim IS 20 75 to window face
- Remove backing strip
- Flatten prefold down, and press tape along length of corner
- Repeat on opposite jamb

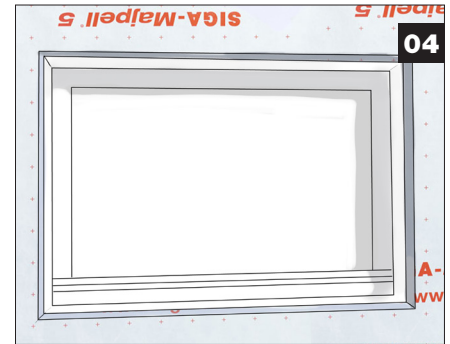

- Repeat Steps 1 & 2 (above) to seal head
- Press firmly on all tape connections
- How it should look



**Fentrim® IS 20 75**

p. 31

## Majvest® Facade membrane and roof membrane



3 m x 50 m = 150 m<sup>2</sup> / 22 kg  
9.8 ft x 164 ft = 1614 ft<sup>2</sup> / 48.50 lb  
Item no. 8910-300050

1.5 m x 50 m = 75 m<sup>2</sup> / 11 kg  
4.9 ft x 164 ft = 807 ft<sup>2</sup> / 24.25 lb  
Item no. 8910-150050

- ✓ 3-layer, tear-proof and flexible  
can be laid easily,  
quickly and securely
- ✓ ideal for roof and facade  
for all-purpose application
- ✓ cutting and bonding aid  
saves time



### tips and tricks

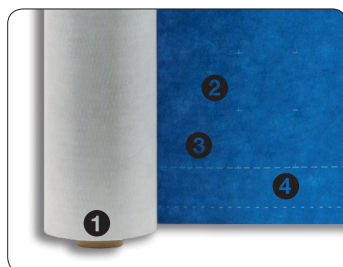

- Protruding roll core ① protects Majvest right up to the last inch
- The cutting aid ②, laying aid ③ and bonding aid ④ save time

3 layered, microporous functional layer,  
reinforced on both sides with PP fibre-fleece  
Thickness: 0.5 mm / 0.02"  
Weight per unit area: 136 g/m<sup>2</sup> / 0.45 oz/ft<sup>2</sup>  
CE, EN 13859-2  
The Technical Data Sheets include ASTM testings.  
They are available on [www.sigacover.com](http://www.sigacover.com).  
s<sub>d</sub> value: 0.05 m | 68 US perms  
Atmospheric exposure: up to 3 months  
Waterproof: W1 in accordance with EN 1928  
Fire behaviour: class E in accordance with DIN 13501-1

## Wigluv® 60

single-sided high-performance tape  
for overlaps, penetrations and windows



- ✓ high adhesive strength at high  
and low temperatures  
reliable, long-term building value
- ✓ vapor-permeable > 1.7 US perms  
prevents condensation build-up
- ✓ resistant to driving rain and  
impermeable to water  
permanent protection for  
roof and facade

### Wigluv® 60

Item no.: 7510-6040  
Box: 10 rolls  
Roll: width x length: 60 mm x 40 m  
2.4" x 131 ft



Vapor permeable special PO film (> 1.7 US perms), hand-tearable, elastic, impermeable to water,  
UV-stable (12 months atmospheric exposure), The bond must not be under standing water.  
Europ. Patent 1847577

## Dockskin®

The high performance primer for sealing sandy,  
fibrous substrates



- ✓ quick drying  
short waiting time in combination  
with SIGA-Wigluv® and SIGA-Rissan®
- ✓ strong penetration  
extremely good adhesion on  
soft fiber boards,  
masonry and concrete
- ✓ usable on cold substrates  
from -10°C / 14°F  
solvent-free

### Dockskin®

Weight: 1 kg / 2.2 lb  
Item no.: 5930  
Box: 8 cans  
Coverage Rissan 100: ~35 m / 115 ft  
Coverage Rissan 150: ~25 m / 82 ft



Solvent-free, water-based acrylate copolymer dispersion.  
Shelf life: 18 months from the date of sale if unopened. Clean the brush immediately with water.  
Keep out of reach of children!

## Fentrim® F High-performance tape for window flashing



- ✓ high adhesive strength at high and low temperatures  
easy to apply, immediately 100 % tight
- ✓ robust, fleece-backed carrier material  
reliable, long-term building value
- ✓ no primer required for masonry  
saves time, eliminates process mistakes



**Fentrim F 4" Fentrim F 6" Fentrim F 9" Fentrim F 12"**

Item no.:	9712-10025	9712-15025	9712-23025	9712-30025
Box:	6 rolls	4 rolls	2 rolls	2 rolls
Roll: width x length:	100 mm x 25 m	150 mm x 25 m	230 mm x 25 m	300 mm x 25 m
	4" x 82 ft	6" x 82 ft	9" x 82 ft	12" x 82 ft

vapor permeable special PO film (>1.7 US perms), fleece-backed, formable, impermeable to water, UV- stable (atmospheric exposure 3 months), avoid permanent exposure to ponding water.  
Europ. Patent: 1339924 US Patent No. 7.445.828 B2

## Fentrim® IS 2 75

High-performance tape resistant to driving rain for window and door frames, for outdoor application



- ✓ high adhesive strength at high and low temperatures  
reliable, long-term building value
- ✓ 15 mm pre-folded, without backing strip  
fastest bonding to window frames
- ✓ bonding from -10°C / 14°F  
fast and tight window installation all year-round

**Fentrim® IS 2 75**

Item no.:	9612-156025
Box:	8 rolls
Roll: width x length:	15 / 60 mm x 25 m
	0.6 / 2.4" x 82 ft

vapor permeable special PO film (>1.7 US perms), fleece-backed, formable, impermeable to water, UV- stable (atmospheric exposure 3 months), avoid permanent exposure to ponding water.  
Europ. Patent: 1339924 US Patent No. 7.445.828 B2

## Wigluv® 100/150/230 High-performance tape for bonds, transfers and penetrations



- ✓ high adhesive strength at high and low temperatures  
reliable, long-term building value
- ✓ vapor-permeable > 1.7 US perms  
prevents condensation build-up
- ✓ slit backing strip  
simple and quick to apply



**Wigluv® 100 Wigluv® 150 Wigluv® 230**

Item no.:	7510-10025	7510-15025	7510-23025
Box:	6 rolls	4 rolls	2 rolls
Roll: width x length:	100 mm x 25 m	150 mm x 25 m	230 mm x 25 m
	3.9" x 82 ft	5.9" x 82 ft	9.06" x 82 ft



Vapor permeable special PO film (> 1.7 US perms), hand-tearable, elastic, impermeable to water, UV-stable (atmospheric exposure of 12 months), the seal must not be under standing water.  
Europ. Patent 1847577

## Wigluv® 20/40

single-sided high-performance tape for overlaps, penetrations and windows



- ✓ slit and tearproof backing strips 20/40  
precise and quick in corners
- ✓ vapor-permeable > 1.7 US perms  
prevents condensation build-up
- ✓ high adhesive strength at high and low temperatures  
reliable, long-term building value

**Wigluv® 20/40**

Item no.:	7510-6025
Box:	10 rolls
Roll: width x length:	20 / 40 mm x 25 m
	0.75" / 1.5" x 82 ft



Vapor permeable special PO film (> 1.7 US perms), hand-tearable, elastic, impermeable to water, UV-stable (12 months atmospheric exposure), The bond must not be under standing water.  
Europ. Patent 1847577



## Majpell® 5 the vapor control layer for roof, wall and ceiling structures

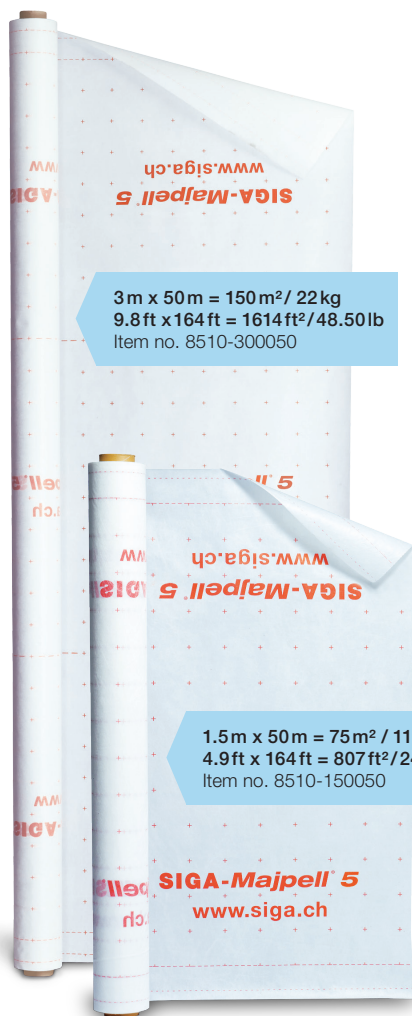

3m x 50m = 150m<sup>2</sup> / 22kg  
9.8ft x 164ft = 1614ft<sup>2</sup> / 48.50lb  
Item no. 8510-300050

1.5m x 50m = 75m<sup>2</sup> / 11 kg  
4.9ft x 164ft = 807ft<sup>2</sup> / 24.25lb  
Item no. 8510-150050

- ✓ for between-rafter insulation  
just 1 vapor control layer for all  
common constructions
- ✓ sturdy, flexible and  
dimensionally stable  
can be laid quickly,  
easily and without wrinkles
- ✓ vapor-permeable,  
fixed US perms 0.68  
intelligent moisture management



### tips and tricks

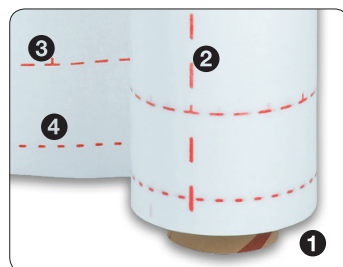

- Protruding roll core ① protects  
Majpell right up to the last inch
- The cutting aid ②, laying aid ③ and  
bonding aid ④ save time

PO layer, reinforced with PP fibres  
thickness 0.4 mm / 0.016"  
Weight per unit area: 126 g/m<sup>2</sup> / 0.43 oz/ft<sup>2</sup>  
CE, EN 13984, type A  
The Technical Data Sheets include ASTM testings.  
They are available on [www.sigacover.com](http://www.sigacover.com).  
UV-stable up to 3 months  
Fire behaviour: class E (according to EN 13501-1)  
sd value: 5 m | 0.68 US perms

Stick with us.

## Rissan® 60

single-sided high performance tape for circular penetration  
and for overlaps on wood-based panel material



- ✓ extremely strong adhesion  
reliable, long-term building value
- ✓ smooth carrier material  
clings tightly around pipes  
and cables
- ✓ elastic  
keeps joints sealed despite  
structural movements

### Rissan® 60

Item no.: 2510-6025  
Box: 10 rolls  
Roll: width x length: 60 mm x 25 m  
2.4" x 82 ft



Special, reinforced PE film, elastic  
The bond must not be under standing water

## Fentrim® IS 20 75

Airtight high-performance tape for window  
and door frames, for indoor application



- ✓ high adhesive strength at  
high and low temperatures  
reliable, long-term building value
- ✓ 15 mm pre-folded,  
without backing strip  
fastest bonding to window frames
- ✓ bonding from -10°C / 14°F  
fast and tight window  
installation all year-round

### Fentrim® IS 20 75

Item no.: 9611-156025  
Box: 8 rolls  
Roll: width x length: 15 / 60 mm x 25 m  
0.6 / 2.4" x 82 ft

vapor permeable special PO film (0.17 US perms), fleece-backed, formable, impermeable to water,  
UV- stable (atmospheric exposure 3 months), avoid permanent exposure to ponding water.  
Europ. Patent: 1339924 US Patent No. 7.445.828 B2

[www.sigacover.com](http://www.sigacover.com)



# SIGA RELIABILITY

## Product properties

SIGA products have the properties set forth in the Technical Data Sheet (available at <http://www.sigacover.com/us/downloads.html>). However, the properties of SIGA products cannot be guaranteed, and SIGA declines any liability for any product failure, if products are not handled, installed or used in strict compliance with SIGA's written instructions or in the following circumstances:

- In case of unusual influences on the product, in particular of chemical or mechanical nature
- If permanent mechanical strain (e.g. due to tensile and compression forces) has an impact on the seal
- Multilayered sheeting or panelling materials without sufficient cohesive strength
- If windtight sealing is performed on a roof pitch of  $< 10^\circ$  /  $< 2 : 12$  rise: run
- In case of open facade cladding with Majcoat / Majvest
- In the case of airtight sealing in sauna and swimming pool applications
- When using Dockskin, if the sealing is not applied with Wigluv, Rissan, Fentrim
- If SIGA Fentrim F / Fentrim IS are plastered over directly
- If SIGA Fentrim is applied directly on to a wood-based softboard
- When the prerequisites for the secure laying of sheeting are not fulfilled: The substructure must be free of any protruding objects which could cause injury, such as screws etc.
- When the prerequisites for reliable sealing are not fulfilled: The substrate must be dry, structurally sound and free of any dirt and grease. It must not be -adhesive-repellent. Before sealing, clean the substrate and sheeting and perform an adhesion test on site. If necessary, strengthen with high-performance primer SIGA-Dockskin.  
**Caution!** The bonds must not be under standing water. Creases or tensions in the sheeting / tape must be relieved by cutting and resealed.

In the IECC (2015) the United States are divided into 8 different climate zones. Accordingly, different zone-related requirements are to be considered with regard to the building shell. For information about the US climate zones, please refer to the International Energy Conservation Code. Consult your planner or building scientist to check whether your planned construction will meet the requirements of the respective climate zone.

### SIGA Early Warning System

Adjustments and new developments to commercially available surfaces, panels and membranes are systematically recorded thanks to the unique SIGA Early Warning System and regularly flow into the further development of SIGA products. Therefore, you should arrange for a regular inventory turnover to ensure that you always have SIGA products that are state-of-the-art in terms of technology and ecology.

### Manual

This manual can become invalid if new knowledge is acquired or new developments are made. The currently valid manual is available at [www.sigacover.com](http://www.sigacover.com)

## Technical details

**Adhesive** SIGA high-performance adhesives are free of solvents, VOC, high boilers, plasticisers, chlorine and formaldehyde. They cannot be removed after application.

**Application temperature** From  $-10^\circ\text{C}$  /  $14^\circ\text{F}$   
Primur cartridge and tubular bag: from  $+5^\circ\text{C}$  /  $41^\circ\text{F}$

**Temperature resistance**  $-40^\circ\text{C}$  to  $+100^\circ\text{C}$  /  $-40^\circ\text{F}$  to  $212^\circ\text{F}$

**Age resistance** Durable adhesive strength; made without rubber, resins or solvents to prevent embrittlement.

**Storage** Store in a cool, dry place in its original box. Store Primur cartridge, Primur tubular bag, and Dockskin in a cool, dry and frost-protected place in their original boxes. Store Majpell, Majcoat, and Majvest in a cool, dry and UV-protected place.

# SIGA PRODUCTS – LIMITED WARRANTY

SIGA Cover, Inc. («SIGA») provides the following non-transferable limited warranty to installers and property owners at the time of installation for the SIGA products identified (the "Products") below:

**Products** This limited warranty applies to the following Products: Twinet, Sicrall 60, Sicrall 170, Rissan 60, Rissan 100, Rissan 150, Primur Roll, Primur Tubular Bag, Primur Cartridge, Corvum 30/30, Corvum 12/48, Dockskin, Wigluv 60, Wigluv 100, Wigluv 150, Wigluv 230, Wigluv black, Nail sealing tape II, Majpell 5, Majcoat, Majvest, Fentrim F, Fentrim IS 2, Fentrim IS 20.

**Limited Warranty** Subject to the warnings set forth on the Product labels, installation instructions and other SIGA documentation, SIGA warrants that for a period of 10 years from date of purchase, the Products will meet or exceed the properties set forth in the applicable Technical Data Sheet (available at [www.sigacover.com/us/product-overview](http://www.sigacover.com/us/product-overview)) in effect at the time of installation. If the Product fails to meet such standards or any properties set forth in the instruction manual, SIGA's sole liability will be, in its sole discretion, to repair or replace the defective Product, or reimburse the installer/property owner who purchased such Product for the amount of the original purchase price paid. SIGA will replace only the defective Product, and such Product will be replaced with a comparable Product being manufactured at the time of replacement. No substitutions of other products or product manufactured by other manufacturers will be permitted.

### Conditions and Exclusions

To qualify for this Limited Warranty:

- You must notify SIGA in the manner and within the time frame, and otherwise comply with the procedure, set forth under "How Do You Obtain Warranty Coverage?" below and follow any instructions given to you by SIGA in connection with your claim;
- You must have exclusively used Products (and not comparable products from other manufacturers) for the specific project for which the defective Product was used;
- You must have stored, handled, installed, used and maintained the Products in strict compliance with SIGA's instructions and warnings in effect from time to time;
- The Products may not previously have been used,
- You must make reasonable efforts to preserve samples of the defective Products and make such samples available to SIGA; and
- The Products may not have been modified by you or any third party without SIGA.

Without limitation, the following are not covered by this Limited Warranty:

- The negligence, gross negligence, or

willful misconduct of any builder, general contractor, installer, building owner, tenant, or any other third party;

- Any application in connection with unusual influences, in particular of a chemical or mechanical nature. Acts of Nature, including but not limited to, fire and lightning, hurricane, high winds, or floods.

- Vandalism, or other property damage caused by any party.

- Defects in the structure or a component of the structure, fault in the selection of any building materials or components of the structure, contamination from chemicals, deterioration of building materials other than the Products, or use or application of the Products other than for the intended purposes as set forth in SIGA's Product descriptions.

- Defects resulting from foreign objects or agents, including without limitation materials that are incompatible with the Products.

- Exposure to climate, the elements, UV or other environmental exposure in excess of that set forth in the applicable Properties Data Sheet or SIGA's instructions.

- Improper installation of the Products, improper building practices or design, non-compliance with applicable building codes or industry standards, or any deviation from approved construction plans or project specifications.

- Failure to store, handle or use the Products in strict compliance with SIGA's instructions and warnings.

### How Do You Obtain Warranty Coverage?

To obtain ensure that Product defects are covered under this Limited Warranty, you must contact SIGA at [technics@sigacover.com](mailto:technics@sigacover.com) or call +1 855-733-7442 x807 no later than thirty (30) days after you discover any apparent or hidden defect, and you MUST provide SIGA with proof of purchase of the Products within the 10 Year warranty period, provide a detailed and complete description of the alleged defect and damages and thereafter provide prompt and complete responses to any inquiries from SIGA or its agents. You must also:

- Provide SIGA with a reasonable opportunity to inspect the building within [sixty (60)] days after SIGA receives notice of your potential claim;
- Make samples of the defective Products available to SIGA (or grant SIGA access to such samples) in sufficient quantities in order to perform testing to determine whether the Product did not comply with the warranty provided hereby (please note that if the required samples cannot be made available to SIGA, or SIGA cannot be given access thereto, without unreasonable efforts, then, in the alternative, SIGA may use retainer samples from the same lot as the defective Products as those used in the actual installation to determine such compliance).

### Exclusions

THE FOREGOING WARRANTY IS EXPRESSLY MADE IN LIEU OF ANY AND ALL OTHER WARRANTIES, WHETHER EXPRESS OR IMPLIED, INCLUDING THE WARRANTIES OF MERCHANTABILITY, FITNESS FOR A PARTICULAR PURPOSE OR NON-INFRINGEMENT, AND ANY AND ALL SUCH IMPLIED WARRANTIES ARE HEREBY EXPRESSLY EXCLUDED AND DISCLAIMED.

SIGA's SOLE LIABILITY UNDER THIS WARRANTY IS LIMITED TO, IN SIGA'S SOLE DISCRETION, THE REPAIR OR REPLACEMENT OF DEFECTIVE PRODUCTS OR REIMBURSEMENT OF THE INSTALLER/ PROPERTY OWNER WHO PURCHASED SUCH PRODUCTS FOR THE AMOUNT OF THE ORIGINAL PURCHASE PRICE PAID IN THE EVENT THE PRODUCTS FAIL TO MEET THE PROPERTIES SET FORTH IN THE APPLICABLE PRODUCT DATA SHEET.

UNDER NO CIRCUMSTANCES SHALL SIGA'S LIABILITY EXCEED \$250,000 OR SHALL SIGA BE LIABLE EITHER IN TORT OR IN CONTRACT FOR ANY DIRECT, INCIDENTAL OR CONSEQUENTIAL DAMAGES, LOST PROFITS, LOST REVENUE, LOSS OF USE OR ANY BREACH OF ANY EXPRESS OR IMPLIED WARRANTY, REPRESENTATION OR CONDITION.

This Limited Warranty is the only warranty made by SIGA with respect to the Products. No representative, dealer or any other person is authorized to make or makes any warranty, representation, condition or promise on behalf of SIGA with respect to the Products. No terms or conditions other than those stated herein or provided by applicable law, and no oral or written agreement, understanding, promise, or commitment, may in any way modify this warranty without SIGA's express prior written consent, and no such modification may be relied upon by any party or under any circumstances other than the party for which, and the circumstances under which, such modification is granted.

### THIS LIMITED WARRANTY IS NOT A PERFORMANCE CLAIM.

This Limited Warranty is effective for Products purchased and installed after January 2013 in Canada and the United States. If any Products are replaced under this warranty, the warranty coverage will continue from the original date of purchase and not from the date of repair or replacement.

For more information about this Limited Warranty, please contact your local SIGA representative or SIGA DIRECTLY at [technics@sigacover.com](mailto:technics@sigacover.com) or +1 855-733-7442 x807.

## FOR DIFFERENT SUBSTRATES THE RIGHT SIGA HIGH-PERFORMANCE ADHESIVE

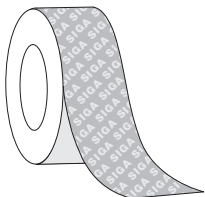

	<b>Rissan® 60</b>	<b>Wigluv® 60</b>	<b>Wigluv® 100</b>	<b>Wigluv® 150</b>	<b>Wigluv® 230</b>	<b>Wigluv® 20/40</b>	<b>Fentrim® IS 20</b>	<b>Fentrim® IS 2</b>	<b>Fentrim® F</b>
Wood	✓	✓	✓	✓	✓	✓	✓	✓	✓
Hard wood-based panel materials	✓	✓	✓	✓	✓	✓	✓	✓	✓
Softboards			✓*	✓*	✓*		✓*	✓*	✓*
Gypsum plaster boards / gypsum fibre boards	✓	✓	✓	✓	✓	✓	✓	✓	✓
Cement fibre boards	✓	✓	✓	✓	✓	✓	✓	✓	✓
Concrete, masonry, plaster			✓*	✓*	✓*		✓	✓	✓
Bituminous sheeting in the base area			✓	✓	✓		✓	✓	✓
Rigid insulation (EPS/XPS/PU)	✓	✓	✓	✓	✓		✓	✓	✓
Metal	✓	✓	✓	✓	✓	✓	✓	✓	✓
Hard plastics	✓	✓	✓	✓	✓	✓	✓	✓	✓
Electric cables	✓	✓	✓	✓	✓	✓	✓	✓	✓

★ must be reinforced with high-performance primer **Dockskin®**

If necessary, strengthen all above mentioned substrates with high performance primer **Dockskin®**.

**Note:** For the correct choice of product for the intended application, the substrate matrix, the application recommendations and product information in this manual must be considered.

## ABOUT SIGA



✓ **reliable**  
a healthy family-run company  
in its second generation



✓ **professional**  
SIGA production processes  
guarantee the highest quality



✓ **quality**  
SIGA is a manufacturer of high  
performance adhesive tapes  
with its own quality control



✓ **trainings**  
on site support and workshops,  
every year SIGA trains hundreds  
of contractors and architects

**SIGA**  1966 Stick with us.

[www.sigacover.com](http://www.sigacover.com)

